

# EC centrifugal fans and modules

backward curved, Ø 355



- **Material:** Support bracket: Steel, coated in black  
Support plate: Galvanised sheet steel  
Impeller: Sheet aluminium, laser-welded  
Rotor: Coated in black  
Electronics enclosure: Die-cast aluminium
- **Number of blades:** 7
- **Direction of rotation:** Clockwise, seen on rotor
- **Type of protection:** IP 54 (acc. to EN 60529)
- **Insulation class:** "F"
- **Mounting position:** Shaft horizontal or rotor on bottom; rotor on top on request
- **Condensate discharges:** Rotor-side
- **Mode of operation:** Continuous operation (S1)
- **Bearings:** Maintenance-free ball bearings

## Nominal data

Type	Motor	Curve	Nominal voltage range VAC	Frequency Hz	Speed/rpm <sup>(1)</sup> rpm	Max. power input <sup>(1)</sup> W	Max. current draw <sup>(1)</sup> A	Perm. amb. temp. °C	Electr. connection p. 45
*3G 355	M3G 112-EA	Ⓐ	3~ 380-480	50/60	2140	1000	1,75	-25..+60	L2)

subject to alterations

(1) Nominal data in operating point with maximum load and 400 VAC

## Curves

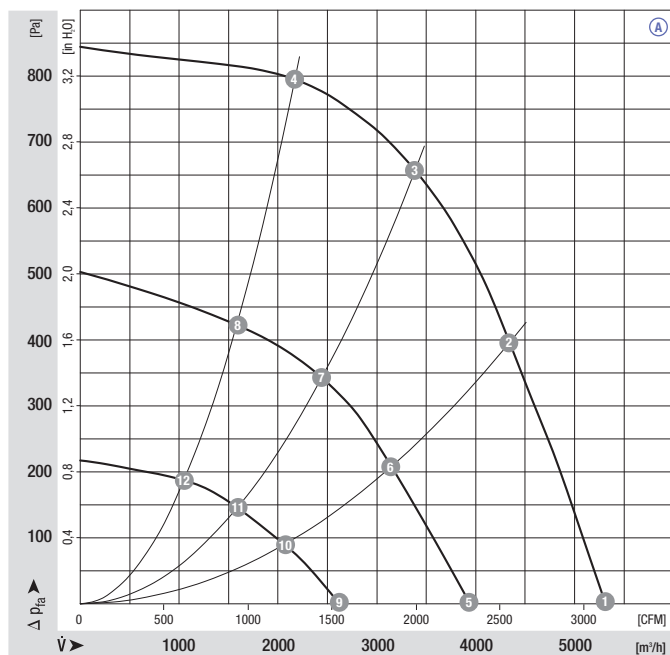

	n [rpm]	P <sub>1</sub> [W]	I [A]	L <sub>wA</sub> [dB(A)]
Ⓐ 1	2140	656	1,14	87
Ⓐ 2	2140	893	1,50	77
Ⓐ 3	2140	1000	1,75	75
Ⓐ 4	2140	918	1,54	78
Ⓐ 5	1610	286	0,57	79
Ⓐ 6	1595	350	0,68	70
Ⓐ 7	1580	387	0,74	69
Ⓐ 8	1585	366	0,70	70
Ⓐ 9	1080	113	0,28	71
Ⓐ 10	1065	133	0,31	64
Ⓐ 11	1065	143	0,33	60
Ⓐ 12	1060	135	0,32	61

- **Technical features:**
    - PFC (passive)
    - Integrated PID controller
    - Control input 0-10 VDC / PWM
    - Input for sensor 0-10 V or 4-20 mA
  - **EMC:** Interference emission acc. to EN 61000-6-3  
Interference immunity acc. to EN 61000-6-2  
Harmonics acc. to DIN EN 61000-3-2/3
  - **Leakage current:** < 3.5 mA acc. to EN 61800-5-1
  - **Connection leads:** Via terminal strip
  - **Protection class:** I (acc. to EN 61800-5-1)
  - **Product conforming to standard:** CE
  - **Approvals:** VDE, UL, CSA, CCC, GOST are applied for
- Slave output 0-10 V max. 3 mA
  - Output 20 VDC ( $\pm 20\%$ ) max. 50 mA
  - Output 10 VDC ( $+10\%$ ) max. 10 mA
  - RS485 ebmBUS
  - Alarm relay
- Line undervoltage / phase failure detection
  - Motor current limitation
  - Electronics / motor overtemperature protection
  - Locked-rotor protection
  - Soft start

Centrifugal fan	kg	Inlet nozzle with one pressure tap	Centrifugal module w. support bracket	kg	Centrifugal module w. support bracket (2)	kg
R3G 355-AX56 -01	9,8	35675-2-4013	K3G 355-AX56 -02	17,6	K3G 355-AX56 -32	17,6

(2) Centrifugal module with higher protection against corrosion

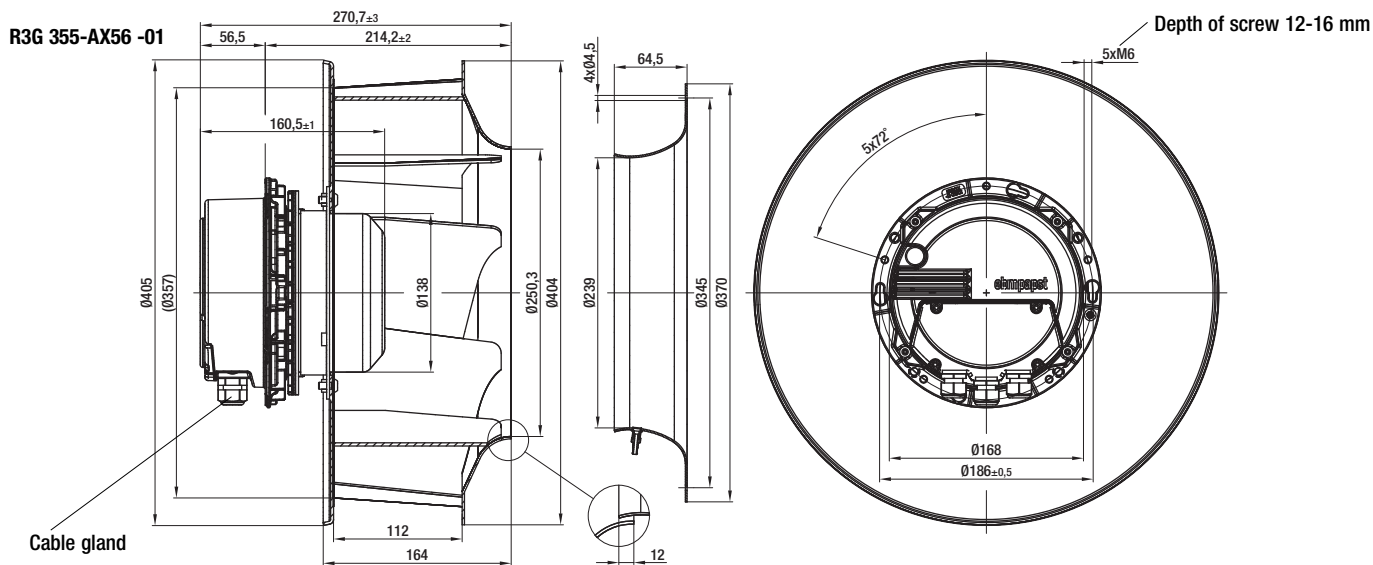

K3G 355-AX56 -02 / -32

